

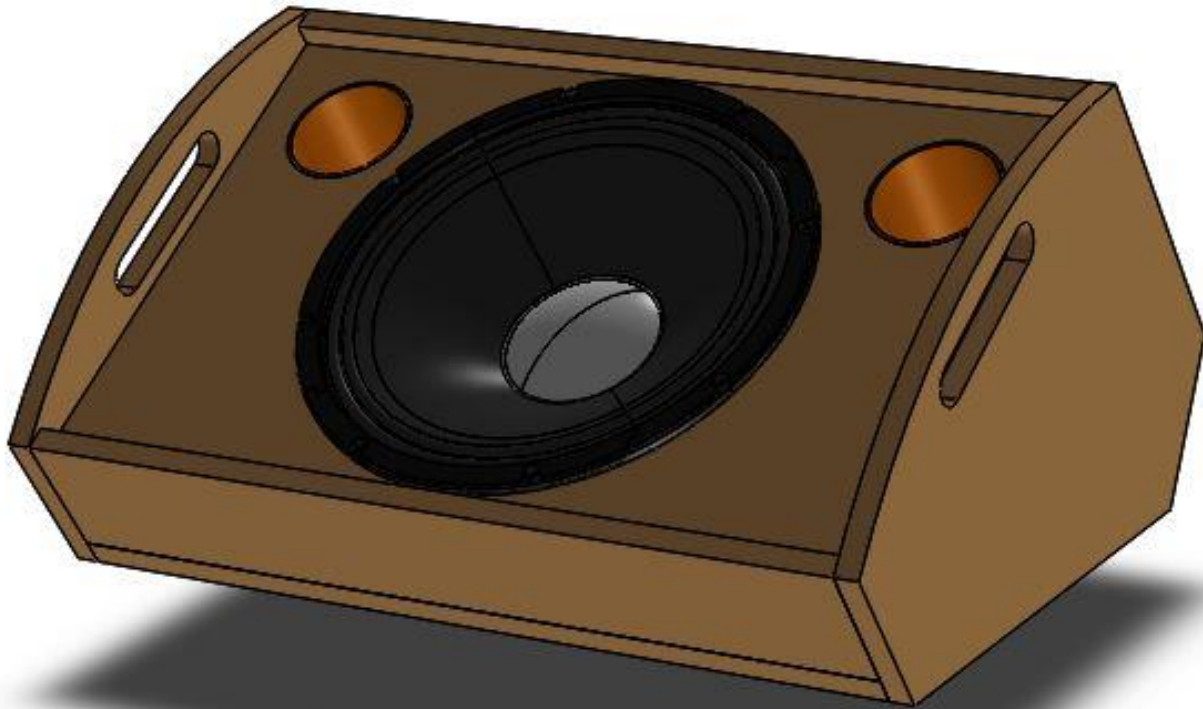

CX12.64

Compact wedge - 12" coaxial speaker

1x12" Coaxial transducer – 12CLX64 8 ohm



TRANSDUCER

12CLX64

8Ω

Coaxials - 12.0 Inches

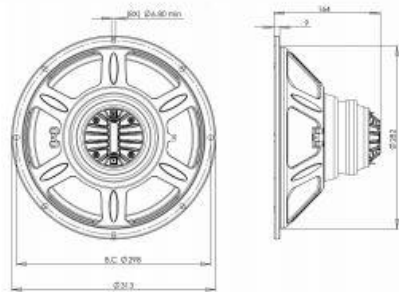

- 500 W continuous program power capacity
- 60° nominal coverage
- 54 - 18000 Hz response
- 96.2 dB sensitivity
- Single Neodymium magnet assembly
- Aluminum demodulating ring for very low distortion

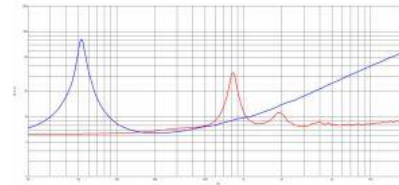
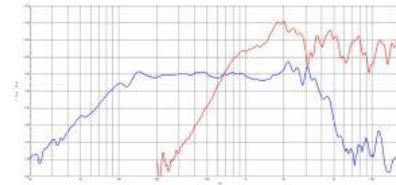

SPECIFICATIONS

Nominal Diameter	320 mm (12.0 in)
Nominal Impedance	8 Ω
Minimum Impedance LF	6.6 Ω
Minimum Impedance HF	7.8 Ω
Frequency Range	54 - 18000 Hz
Dispersion Angle ¹	60 °
Woofer Cone Treatment	WP Waterproof Front Side
Magnet Material	Neodymium Ring

SPECIFICATIONS LF UNIT

Sensitivity ²	96.2 dB
Nominal Power Handling ³	250 W
Continuous Power Handling ⁴	500 W
Voice Coil Diameter	64 mm (2.5 in)
Winding Material	Copper
Flux Density	0.87 T
Former Material	Kapton
Winding Depth	14.5 mm (0.57 in)
Magnetic Gap Depth	8.0 mm (0.31 in)

SPECIFICATIONS HF UNIT

Sensitivity ⁵	106.0 dB
Nominal Power Handling ⁶	70 W
Continuous Power Handling ⁷	140 W
Voice Coil Diameter	51 mm (2.0 in)
Winding Material	Aluminum
Flux Density	1.59 T
Diaphragm Material	HT Polymer
Recommended Crossover ⁸	1.2 kHz
Inductance	0.14 mH

PARAMETERS

Resonance Frequency	54 Hz
Re	5.6 Ω
Qes	0.61
Qms	10.1
Qts	0.57
Vas	74.0 dm ³ (2.61 ft ³)
Sd	522.0 cm ² (80.91 in ²)
ηs	1.82 %
Xmax	± 5.3 mm
Xvar	± 5.5 mm
Mms	45.3 g
Bl	11.86 Txm
Le	0.54 mH
EBP	88 Hz

MOUNTING AND SHIPPING INFO

Overall Diameter	313 mm (12.32 in)
Bolt Circle Diameter	298 mm (11.73 in)
Baffle Cutout Diameter	282 mm (11.1 in)
Depth	164 mm (6.46 in)
Flange and Gasket Thickness	9 mm (0.35 in)
Net Weight	3.3 kg (7.28 lb)
Shipping Units	1
Shipping Weight	4.6 kg (10.14 lb)
Shipping Box	425x425x224 mm (16.73x16.73x8.82 in)

CROSSOVER

SERVICE KIT

LF recone kit	RCK12CLX64B
MF replacement diaphragm	MMD5508

Cx12.64

ENCLOSURE DESIGN

Internal view and notes

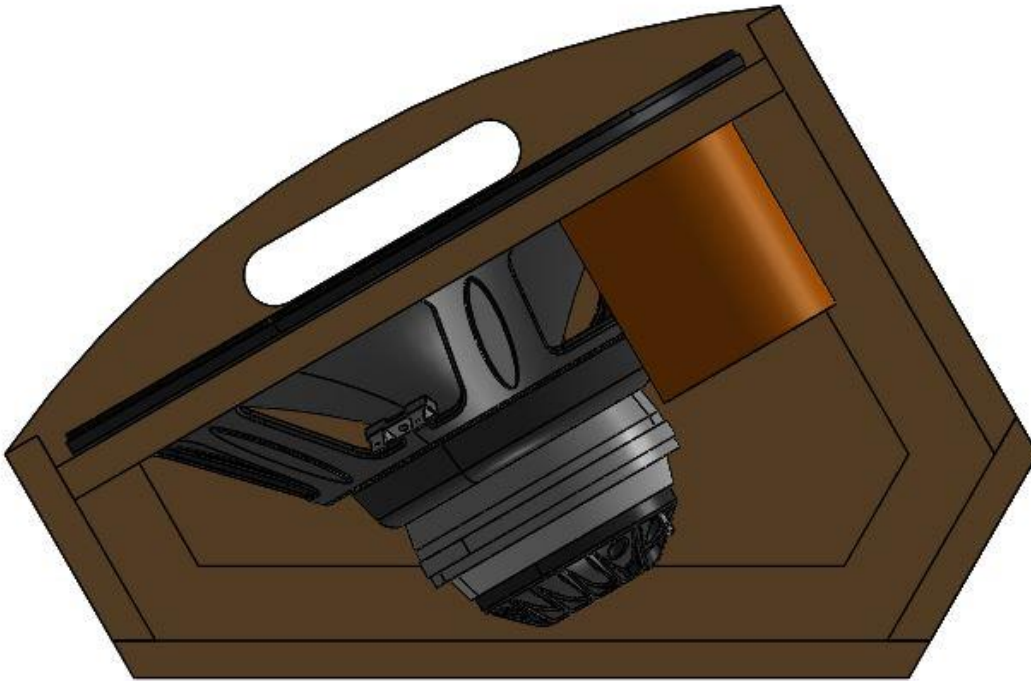

- 15mm Wood thickness (birch plywood suggested)

- A good dampening material should be placed inside the cabinet.

- M5 screws suggested for fixing the transducer.

- Vents have 75mm internal diameter and 100mm depth.

MEASUREMENTS

Unfiltered frequency response 2.83V@1m

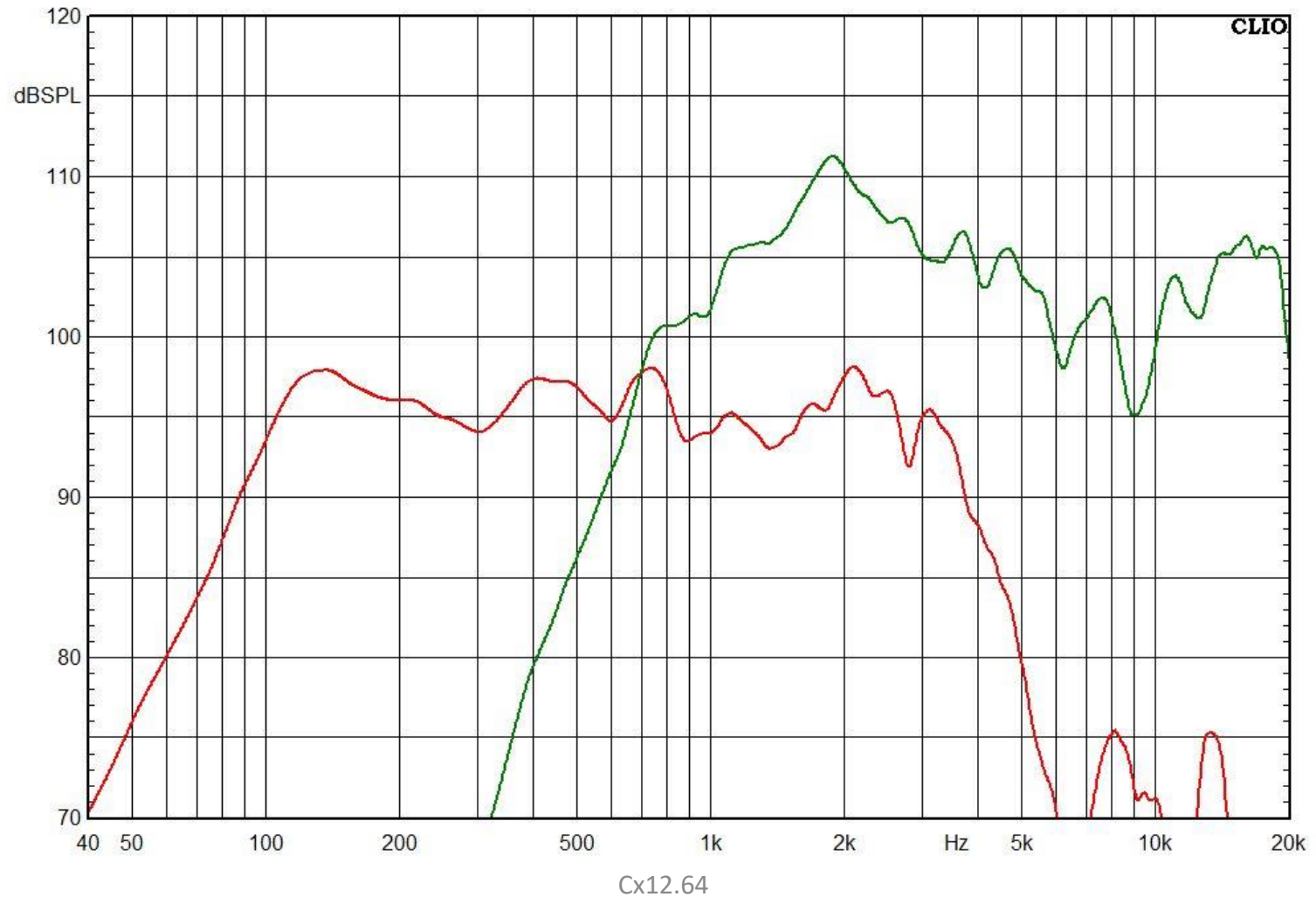

MEASUREMENTS

Impedance @-20dBu input

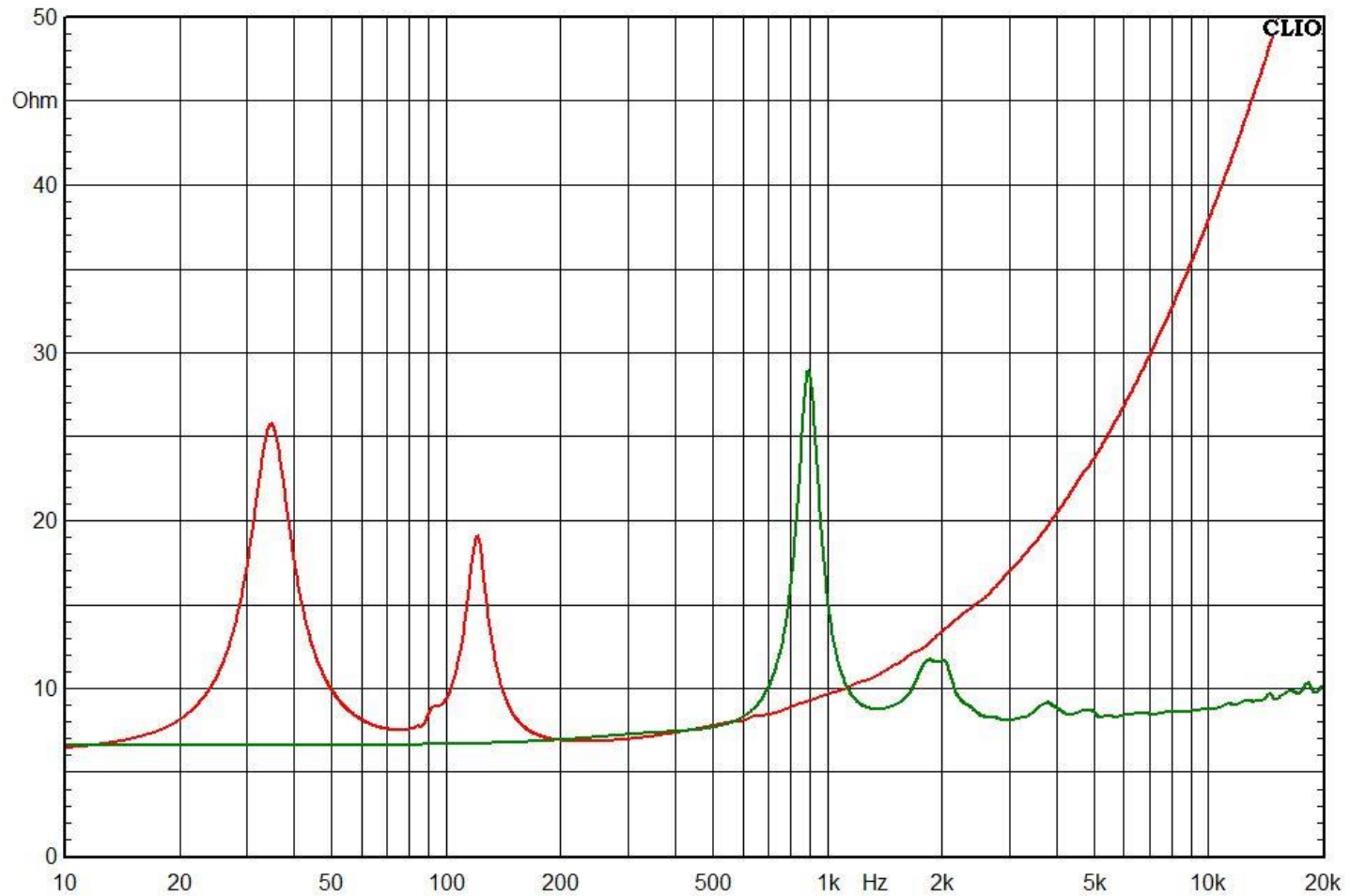

Active dsp settings

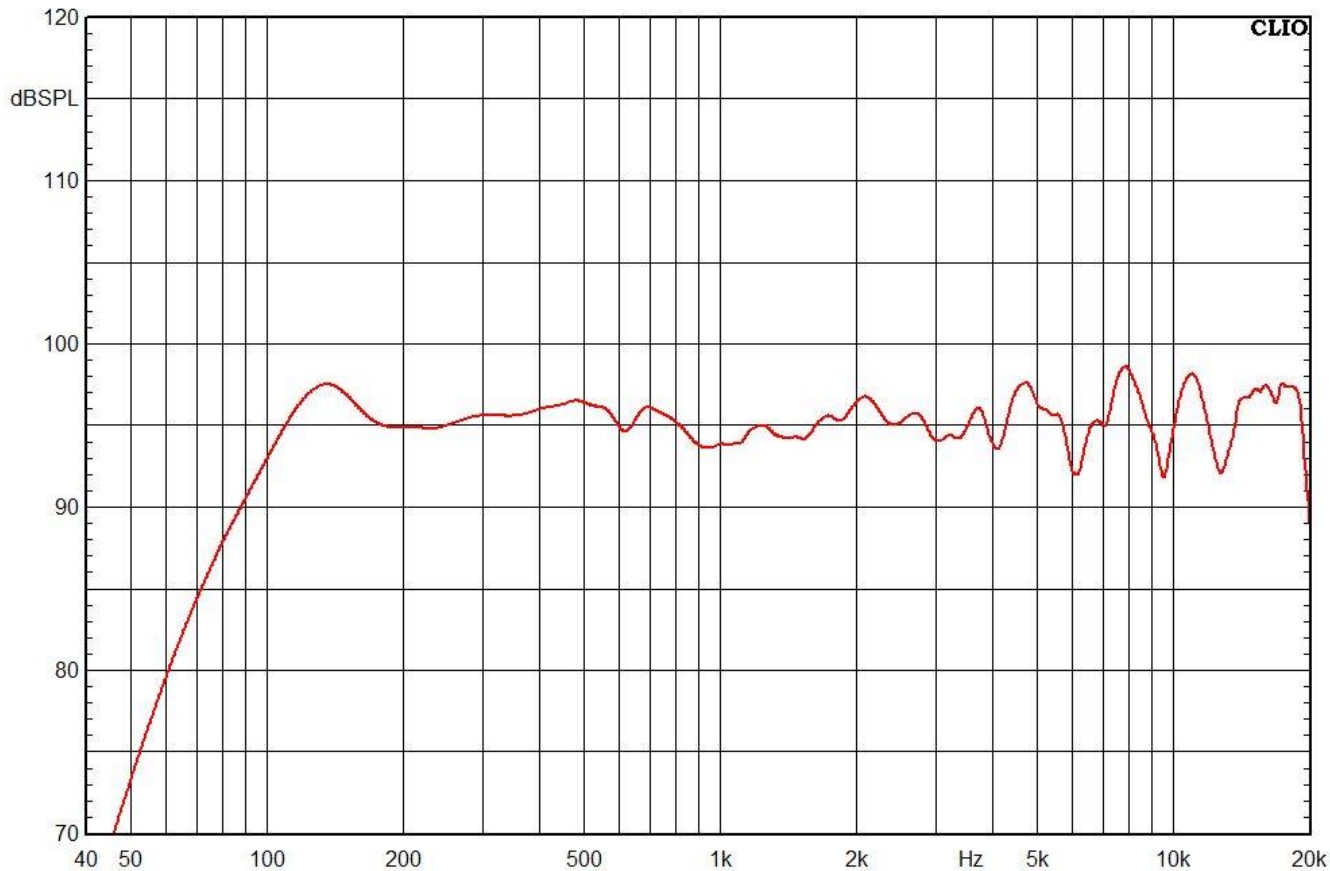

Processed Frequency response

LF:

In: 0dB

HPF: 50Hz – BTW 24dB/Oct

Peaking #1: +3.5dB – Q:2 – Frq: 90Hz

Peaking #2: +2dB – Q:2 – Frq: 280Hz

Peaking #3: +3.5dB – Q:2.5 – Frq: 1300Hz

LPF: 2KHz – BTW 24dB/Oct

HF:

In: -8dB

Phase inverted

Delay: 0.13ms

HPF: 2.5KHz – L-R 24dB/Oct

Peaking #1: -4dB – Q:1.5 – Frq: 2KHz

Peaking #2: +3dB – Q:3 – Frq: 3.2KHz

Peaking #3: +3dB – Q:3 – Frq: 6.2KHz

Peaking #3: +6dB – Q:3 – Frq: 9KHz

Polar map

Directivity index with active dsp settings

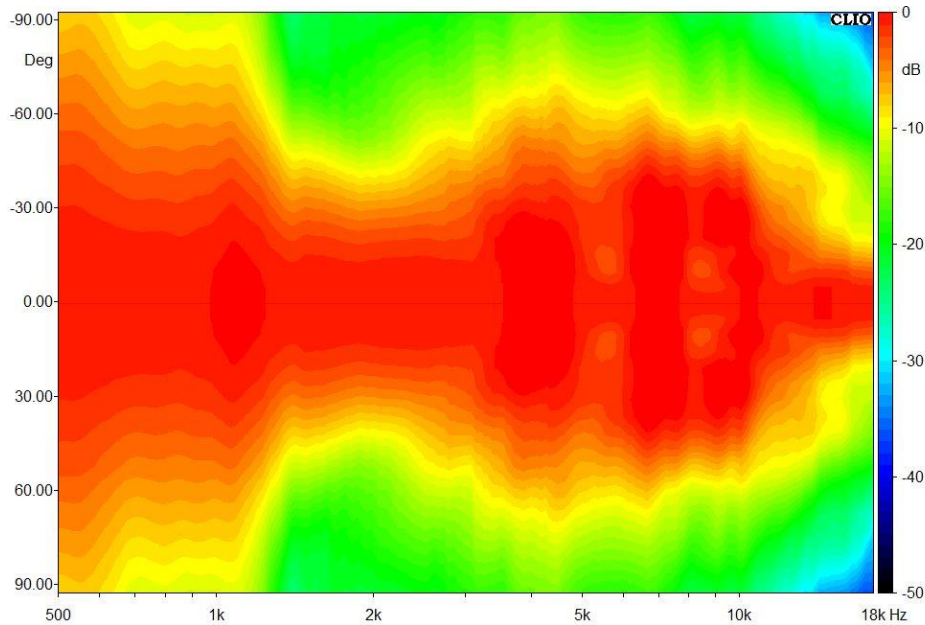

Horizontal plane

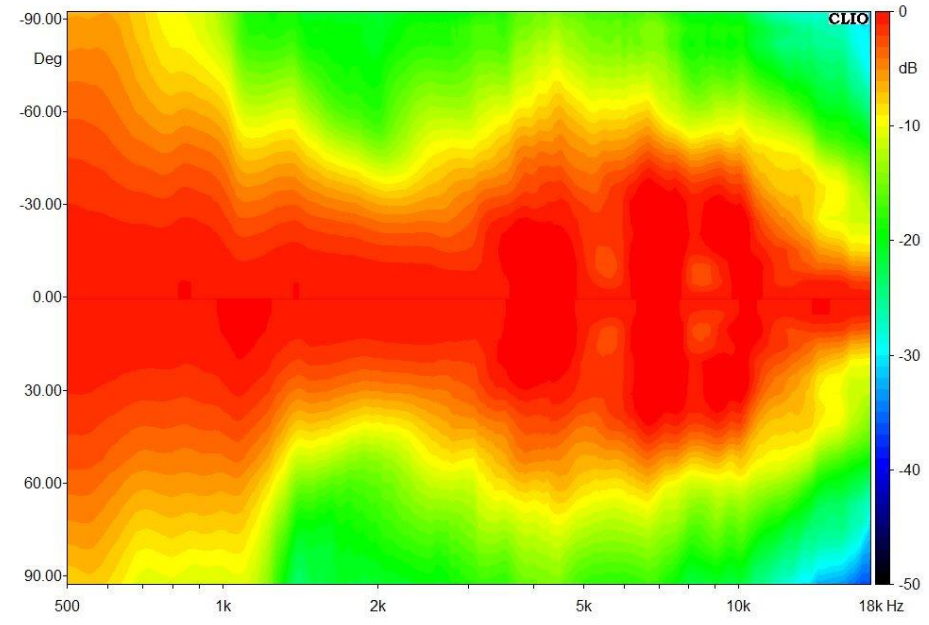

Vertical plane



MEASUREMENTS

*Frequency response @1W-1meter with B&C dedicated passive filter
FBCLX64 (no eq applied)*

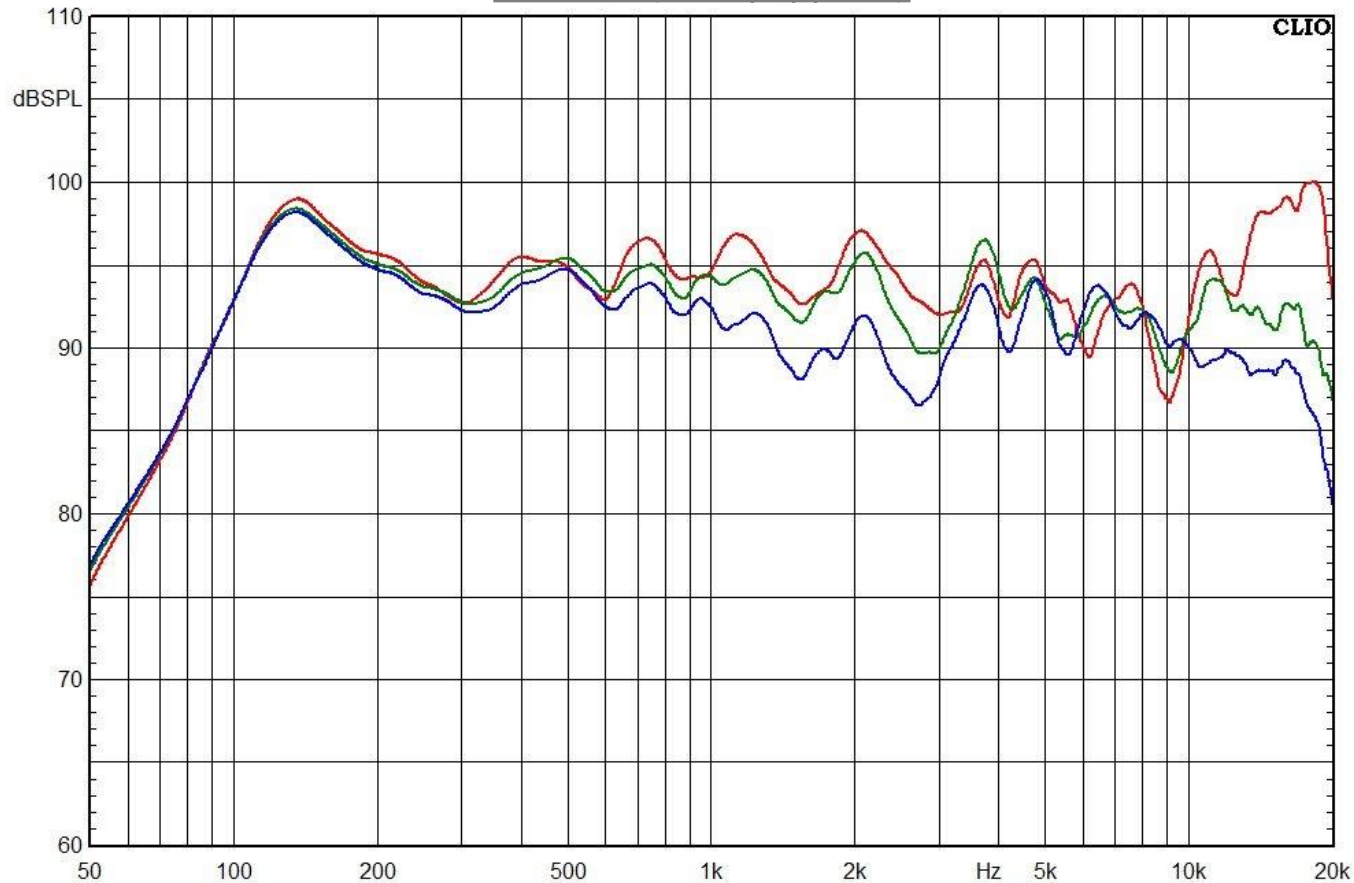

Red – On axis Green – 15° Off axis Blue – 30° Off axis

CX12.64



MEASUREMENTS

Impedance @-20dBu input with B&C dedicated passive filter (FBCLX64)

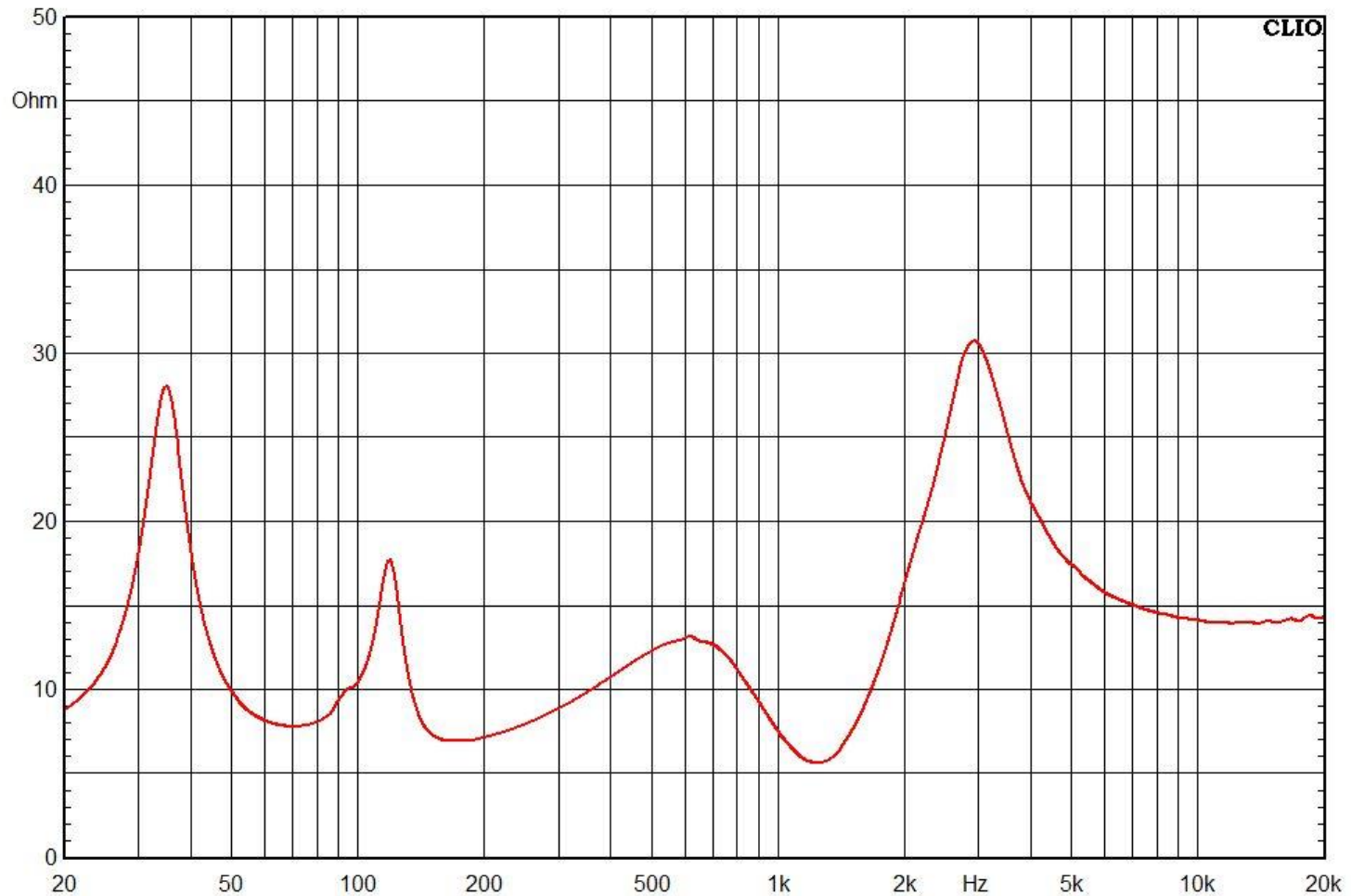

ENCLOSURE DESIGN

Overall dimensions

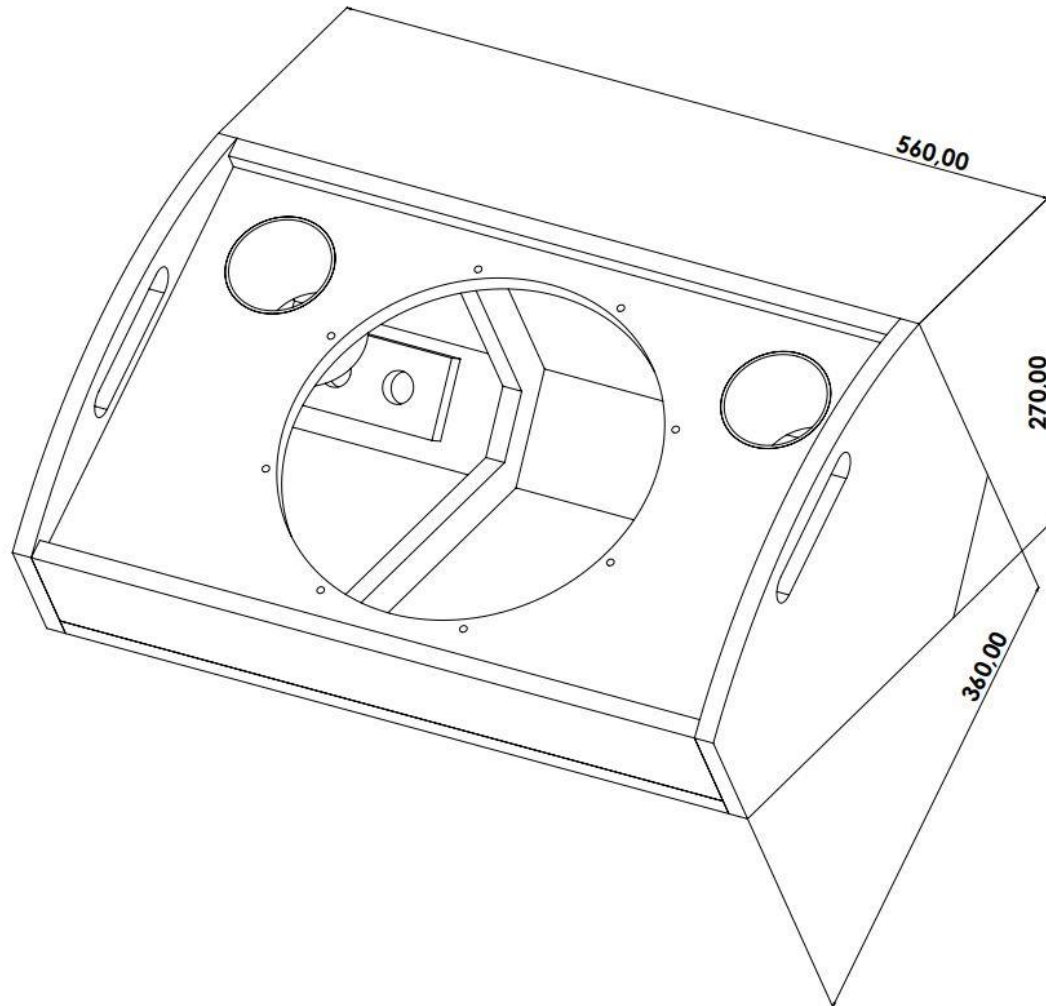

ENCLOSURE DESIGN

Exploded view and parts

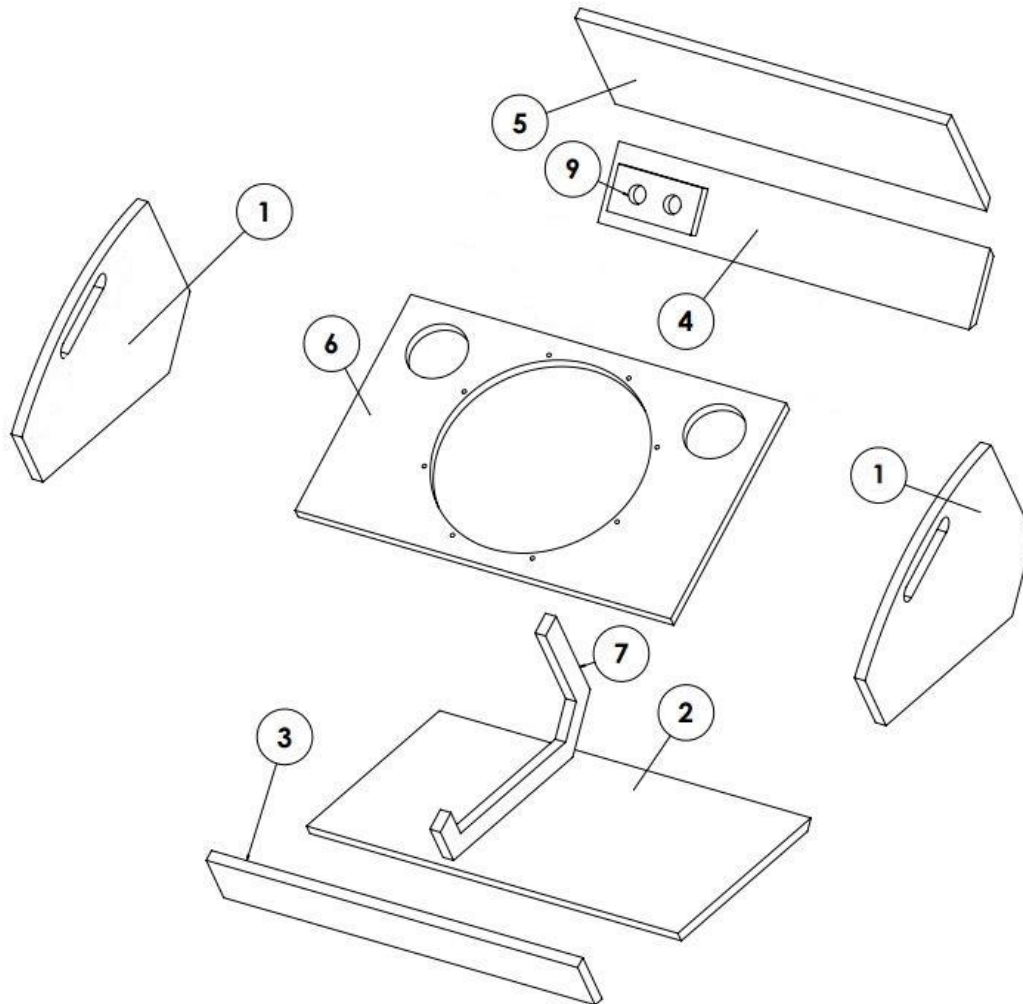

ENCLOSURE DESIGN

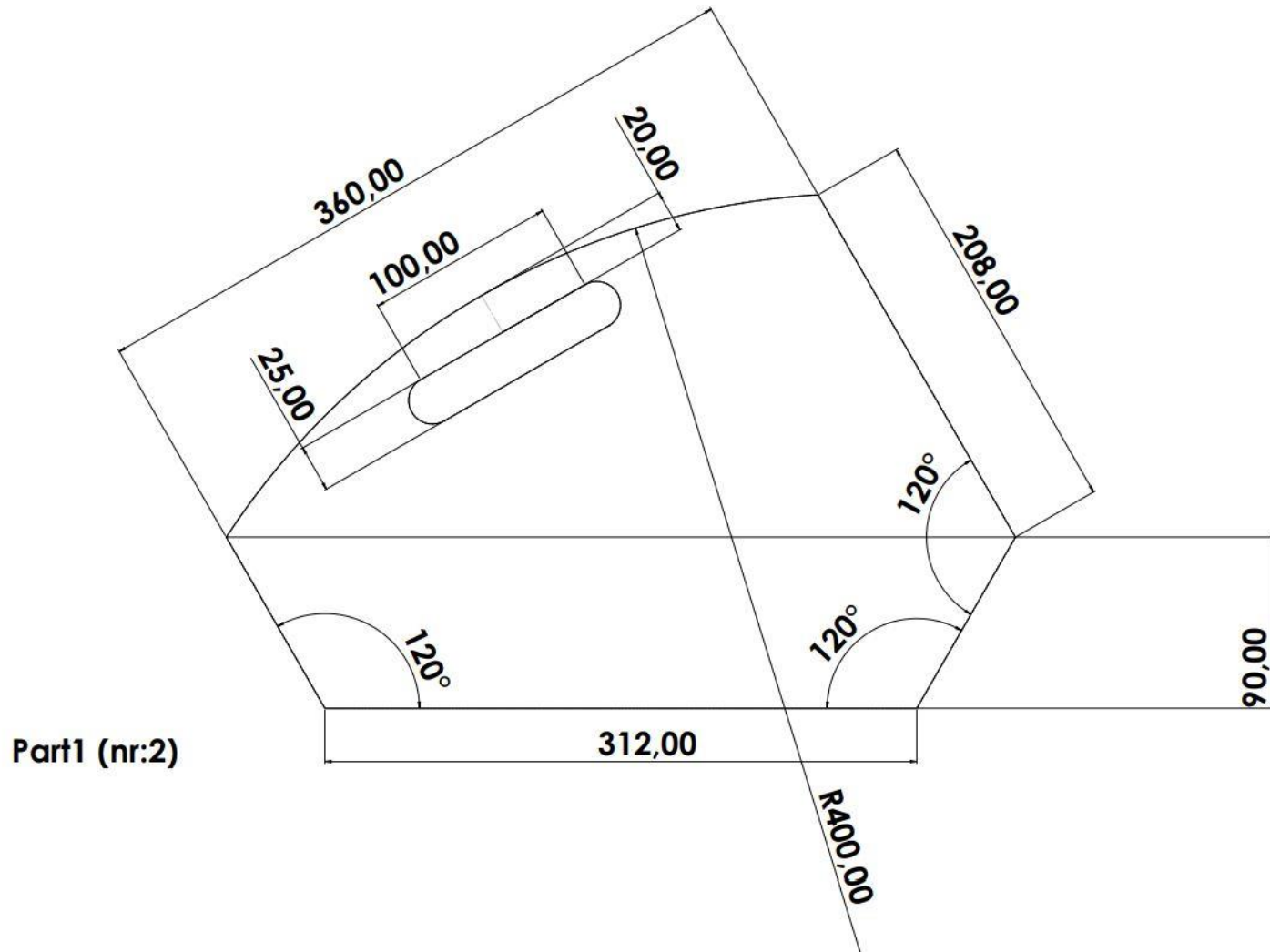

ENCLOSURE DESIGN

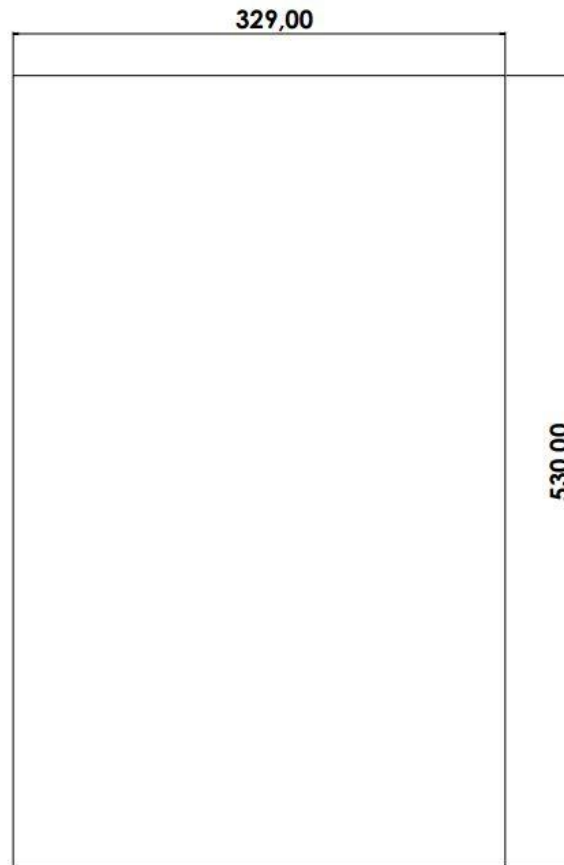

Part2

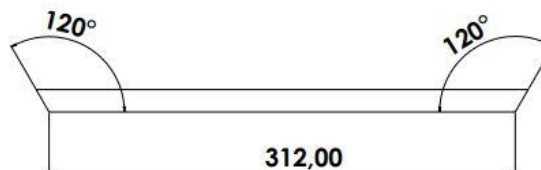

ENCLOSURE DESIGN

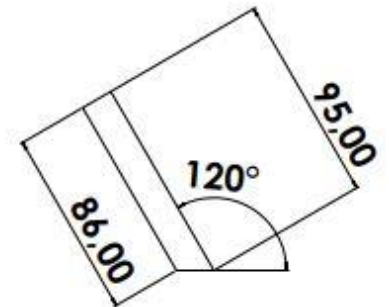
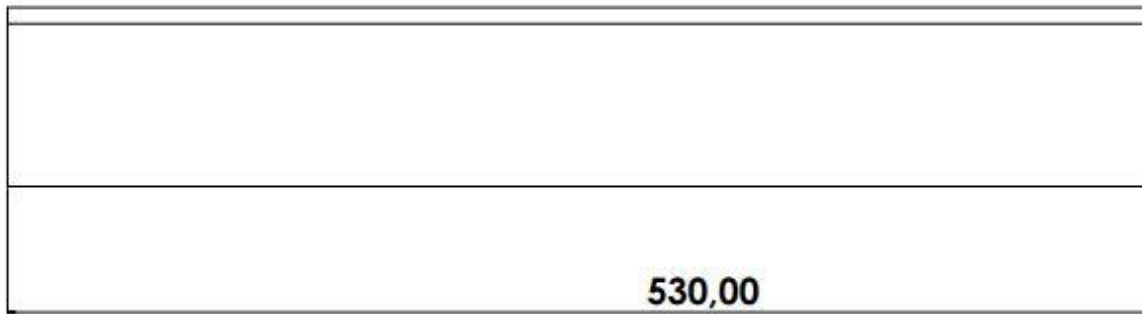

Part3

ENCLOSURE DESIGN

Part4

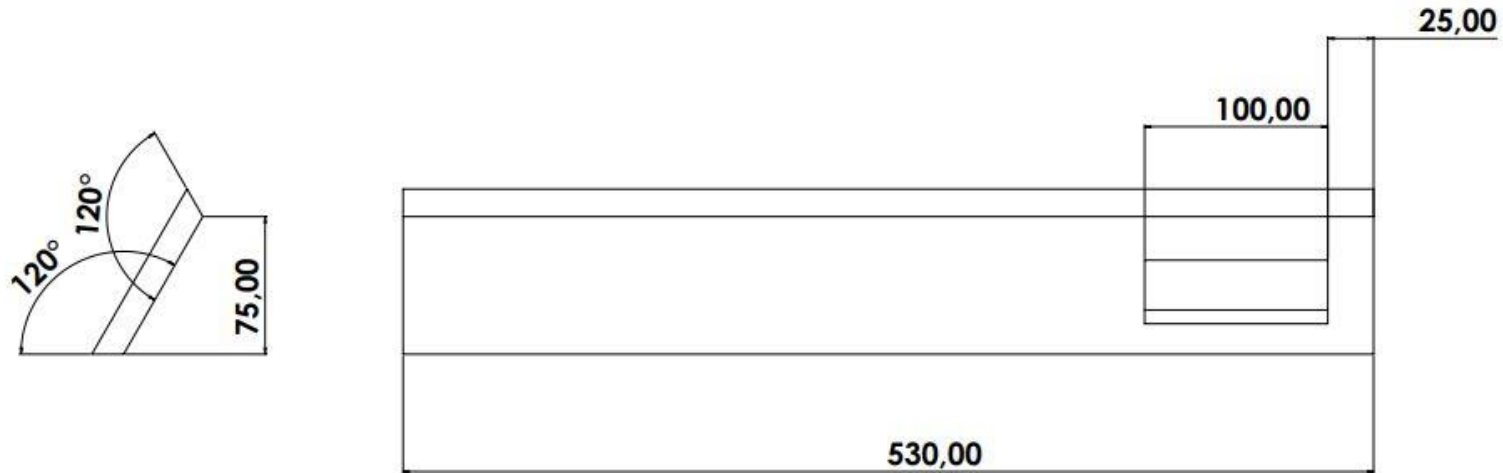

Part9
(Connectors panel)

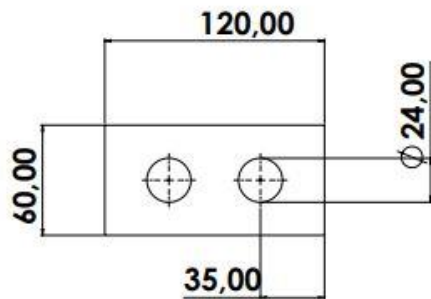

ENCLOSURE DESIGN

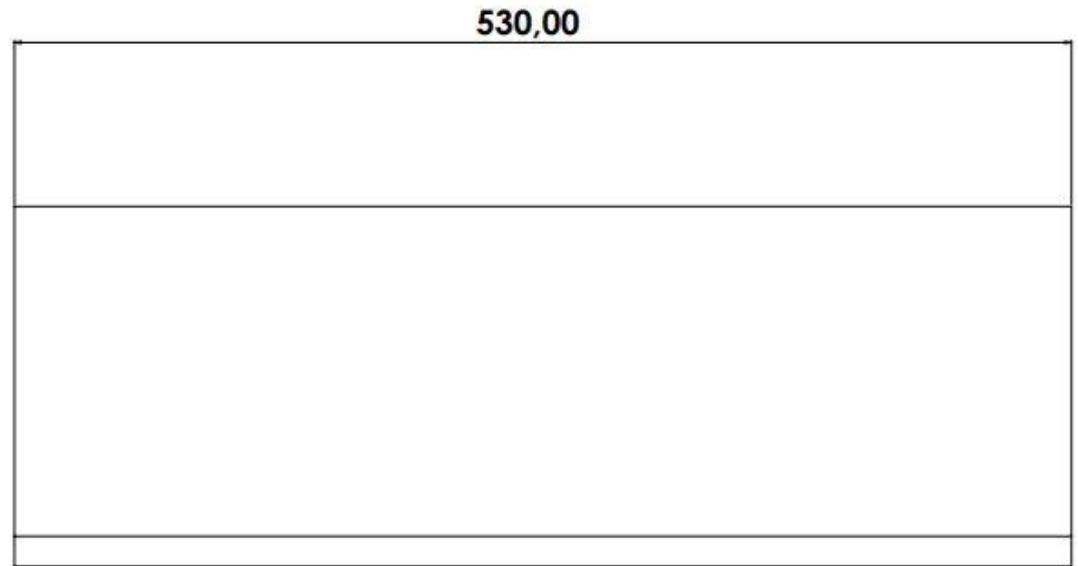
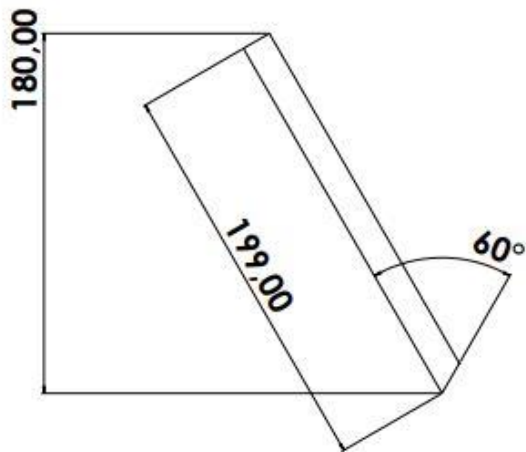

Part5

ENCLOSURE DESIGN

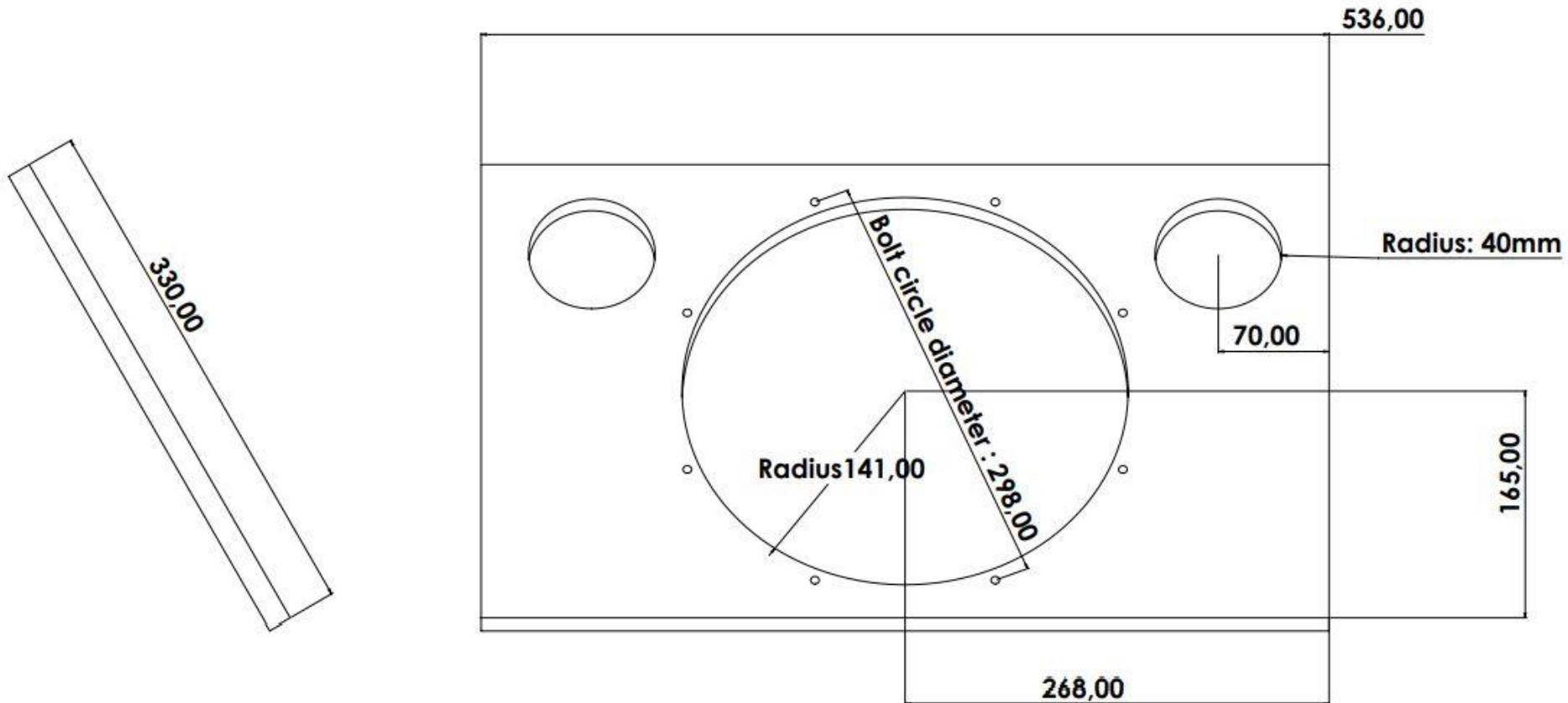

Part 6 (Baffle):
Vents have 75mm internal diameter
and 100mm depth

ENCLOSURE DESIGN

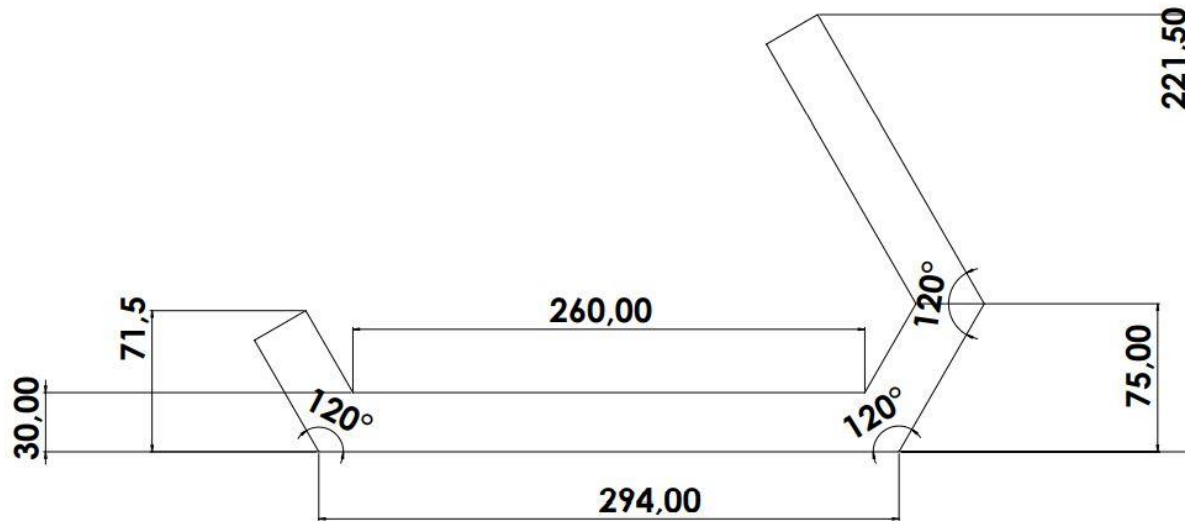

Part7 (Internal reinforcement), to be placed at 180mm from part1